



# 2-WAY STEM VALVES



## 2-WAY STEM VALVES

Two-way valves are the simplest pneumatic component – their function is merely to turn an air supply on or off. They may be compared to a light switch; in the “00” on position electricity flows from supply to the

light, and in the “off” position the electrical current flow is stopped. Two-way stem valves may have a poppet or spool, and, by depressing the stem, a normally closed (NC) valve is opened and a normally open (NO) valve is closed. A variety of actuators may be attached to the valve such as roller cam followers, manual push buttons or pilot actuators; see the Valve Actuators section of this catalog.

**Medium:** Air, Water or Oil

**Materials:** Brass body, Buna-N seals, stainless steel stem and spring

**Stem Travel:** 1/8" (3.2)

supply on or off. They may be compared to a light switch; in the “00” on position electricity flows from supply to the

### Normally-Closed Poppet 2-Way Valves

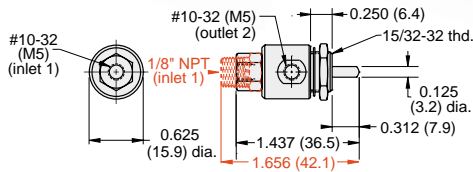

**Input Pressure:** 300 psig/21 bar max.

**Air Flow:** 4.0 SCFM @ 50 psig; 6.8 SCFM @ 100 psig; 170 l/min @ 6 bar

**Force For Full Stem Travel:** 24 oz. nominal

**Mounting:** 15/32-32 thread. Nut and lockwasher furnished.



Part No.	Description
MAV-2 . . . . .	Two-Way Normally-Closed Valve, #10-32
MAV-2-M5 . . . . .	Two-Way Normally-Closed Valve, M5
MAV-2P . . . . .	Two-Way Normally-Closed Valve, 1/8" NPT

### Miniature Poppet Cartridge Valves

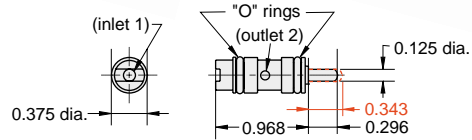

**Input Pressure:** 300 psig

**Air Flow:** 3.0 SCFM @ 50 psig; 6.0 SCFM @ 100 psig

**Force For Full Stem Travel:** 24 oz. nominal

**Mounting:** Inserts into a 3/8" bore (0.375" ±0.001")

**Note:** See page 113 for retaining details

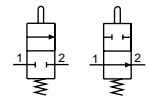

Part No.	Description
MAV-2C . . . . .	Two-Way Normally-Closed Poppet Cartridge Valve
MAVO-2C . . . . .	Two-Way Normally-Open Poppet Cartridge Valve

### N.C. Poppet Valves with Rotatable Inlet

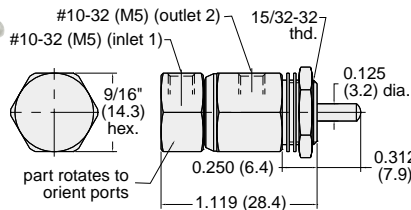
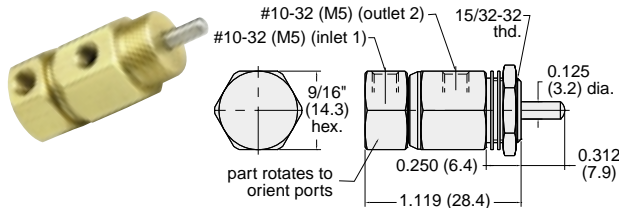

**Input Pressure:** 300 psig/21 bar max.

**Air Flow:** 4.0 SCFM @ 50 psig; 6.8 SCFM @ 100 psig; 170 l/min @ 6 bar

**Force For Full Stem Travel:** 24 oz. nominal

**Mounting:** 15/32-32 thread. Nut and lockwasher furnished.



Part No.	Description
MAV-2R . . . . .	Two-Way Poppet Valve with Rotatable Inlet, #10-32
MAV-2R-M5 . . . . .	Two-Way Poppet Valve with Rotatable Inlet, M5

### Normally-Open Spool Valves

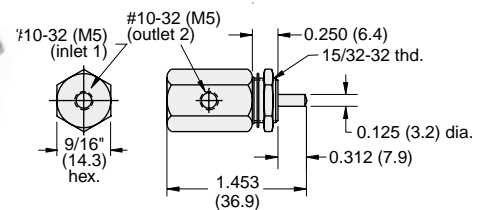
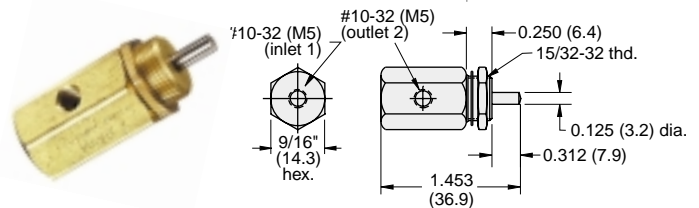

**Input Pressure:** 150 psig/10 bar max.

**Air Flow:** 6.0 SCFM @ 50 psig; 10 SCFM @ 100 psig; 245 l/min @ 6 bar

**Force For Full Stem Travel:** 32 oz. nominal

**Mounting:** 15/32-32 thread. Nut and lockwasher furnished.



Part No.	Description
MAVO-2 . . . . .	Two-Way Normally-Open Stem Valve, #10-32
MAVO-2-M5 . . . . .	Two-Way Normally-Open Stem Valve, M5